

MAINTENANCE / ENTRETIEN / WARTUNG / MANTENIMIENTO

Before conducting maintenance on your pump, consult your instruction manual

Avant de faire l'entretien de votre pompe, consulter le mode d'emploi

Lesen Sie Ihre Gebrauchsanleitung, bevor Sie Ihre Pumpe warten.

Consulte el manual de instrucciones antes de realizar el mantenimiento de la bomba.

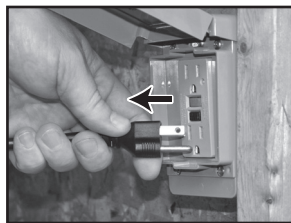

UNPLUG BEFORE SERVICING

DÉBRANCHER AVANT L'ENTRETIEN

TRENNEN SIE SIE VOR DER WARTUNG VOM STROMNETZ

DESENCHUFE ANTES DE REALIZAR EL SERVICIO DE MANTENIMIENTO

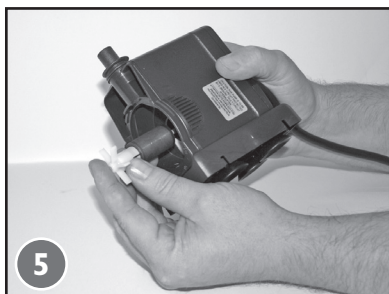
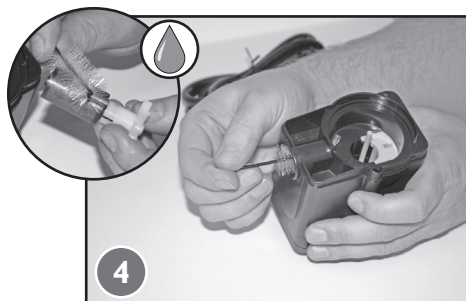
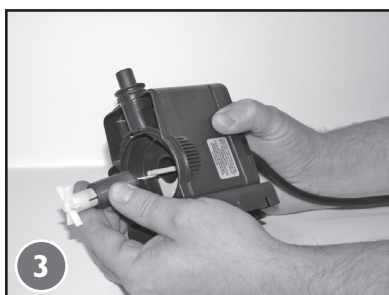

Laguna



QUICK START INSTRUCTIONS SELF CONTAINED WATER FEATURE

Patio Pond

INSTRUCTIONS DE DÉMARRAGE RAPIDE ARRANGEMENT AQUATIQUE INDÉPENDANT

Bassin de jardin

SCHNELLSTARTANLEITUNGEN VOLLSTÄNDIGES WASSERSPIEL

Terrassenteich

INSTRUCCIONES DE MONTAJE DECORACIÓN ACUÁTICA INDEPENDIENTE

Estanque para patio



Distributed by:
Canada: **Rolf C. Hagen Inc.**, Montreal, QC H9X 0A2
U.S.A.: **Rolf C. Hagen (U.S.A.) Corp.**, Mansfield, MA, 02048
U.K.: **Rolf C. Hagen (U.K.) Ltd.**, Castleford, W. Yorkshire WF10 5QH
France: **Hagen France SA.**, F-77388 Combs la Ville.
Germany: **HAGEN Deutschland GmbH & Co. KG.** 25488 Holm
Spain: **Rolf C. Hagen España S.A.**, Av. de Beniparrell n. 11 y 13, 46460 Silla, Valencia
Malaysia: **Rolf C. Hagen (SEA) Sdn Bhd.** 43200 Cheras, Selangor D.E.

Laguna and Hagen are registered trademarks of Rolf C. Hagen Inc.
www.lagunaponds.com
Printed in China
Q-1124-M
Ver: 32/08-INT

Suggested Installation / Installation suggérée / Installationsvorschläge / Instalación sugerida

